



lifepark connect

*Living Life
to the Full*

WWW.CHURCHATLIFEPARK.ORG



living life to the full through

Knowing Christ

- personal spiritual habits
- worship services
- fasting and prayer

Growing in Relationships

- lifegroups
- serving
- care

Sharing the Gospel

- sphere of influence
- local outreach
- missions: local, national & global



WWW.CHURCHATLIFEPARK.ORG



*pathway to membership at
The Church at LifePark*

TABLE OF CONTENTS

1	Letter from our Senior Pastor
2	History
3	Biblical Values
4	Unique Values
5	LifePark Connect 101 Agenda
6	LifePark Vision
7	What We Believe
11	Membership
14	LifePark Connect 201 Agenda
15	Spiritual Habits
18	Pillars of Prayer
19	Spiritual Health Plan
21	LifePark Connect 301 Agenda
22	Pathways to Connection
24	LifePark Connect 401 Agenda
25	Serving Opportunities
28	Sharing the Gospel
31	Organizational Structure
32	Meet our Elders
33	Meet our Staff
35	Ministry Overviews
48	Supplemental Information
	Spiritual Gifts
	Scripture References
	Campus Map
	Covenant

Sunday Mornings 8:30 | 10:00 | 11:30
1151 George Browder Blvd | Mount Pleasant, SC 29466
churchatlifepark.org | 843.654.7600



A NOTE FROM OUR PASTOR

I'm so excited you have decided to attend our LifeParkConnect classes!

Since March of 2010 when our team of 100 or so people opened these doors for the first service, LifePark's desire has been to see the people of North Mount Pleasant come to faith and grow in their relationship with Jesus Christ. And these classes are a key part of that mission.

The Church at LifePark exists to help the people of this community live life to the full by knowing Christ, growing in relationships, and sharing the good news of Jesus. This vision has three focus areas: your personal relationship with God, your relationships within the body of Christ, and your relationships with those who do not know Christ. This LifeParkConnect class series is designed to inform you about each of these areas in order to equip you to live a full, balanced Christian life.

A deeper walk with Christ is established through intentional ministries and relationships, and I hope these Connect classes will help you better understand our church's history, doctrine, culture, ministries, and more in order to inform and help you determine the clear next steps for your faith journey.

Whether you are exploring membership at LifePark or are seeking to become more involved, I am so glad you are here. I pray the Lord will lead and guide you in your next steps. And if you have any questions along the way, please ask!

In John 10:10, Jesus said, "The thief comes only to steal and kill and destroy; I have come that they may have life and have it to the full." We are here to help you live life to the full.

Blessings to you.



Senior Pastor
Chad Moore

HISTORY

The Church at LifePark's story begins 45 years ago. In 1978 members of First Baptist Church of Mount Pleasant purchased 34 acres of property on the north side of Mount Pleasant for \$70,000. At the time, this area was just farmland, but their plan was to one-day plant a new church. The property sat vacant for 30 years. In 2008, First Baptist began drawing up plans for a new sanctuary at their current location on McCants Drive in Old Mount Pleasant. However, several members, stirred by the Holy Spirit, approached church leadership about building on the north property instead. The church council agreed.

But funding was needed. To raise money for the project, First Baptist sold 3.5 acres of the 34 acres for \$3 million.

In the Fall of 2009, while construction was underway, 100 people from First Baptist began meeting on Sunday evenings at Lighthouse Church near the intersection of Highways 17 and 41. These church planters trusted God to do big things: they decided to launch their first service on March 7, 2010 with two services, and 400 people attended! Only God!

In 2020, LifePark expanded again, opening a second building on the property. In the last 12 years, LifePark has continued to grow and flourish in North Mount Pleasant, experiencing God's faithfulness and provision. LifePark has seen hundreds baptized and has over 100 groups meeting each week.

The story of The Church at LifePark cannot be told apart from acknowledging the sovereignty and control of God at every turn. He has been so faithful to our church over the past decade. We have even helped plant several other churches in our area including Kings Cross, Deep Water and Sewee Bay.

As the North Mount Pleasant community and greater Charleston areas continue to expand at a rapid pace, we at LifePark are excited to continue to offer a place for people to gather to learn what it means to live life to the full through knowing Christ, growing in relationship and sharing the Gospel.

BIBLICAL VALUES

- ▶ Authentically Worshiping God: Praising God out of gratitude for His grace
- ▶ Building Loving Relationships: Valuing all people made in the image of God
- ▶ Applying Biblical Truth: Obeying God's Word and trusting all the results to Him
- ▶ Praying With Dependence and Power: Experiencing intimacy with God and asking His will to be done on earth as in heaven
- ▶ Serving in Ministries: Discovering and developing spiritual gifts to serve in ministry
- ▶ Giving Generously: Giving generously of our time, talents and treasures for God's glory
- ▶ Sharing the Gospel: Effectively witnessing in our daily sphere of influence, engaging our city to bring redemption to the broken, planting new biblical churches that will also plant churches and taking the gospel to unreached people groups around the world

LIFEPARK'S UNIQUE VALUES

- ▶ Personal Responsibility: Taking ownership of next steps, learning and applying truth
- ▶ Humility: Recognizing the weaknesses in ourselves and others and creating a gracious environment where we help each other grow in Christ
- ▶ Slowed Down Spirituality: Slowing down to be with Christ before we minister for Christ
- ▶ Generosity: Joyfully and sacrificially using our time, talents and treasure for Kingdom work
- ▶ Respect: Treating people with dignity and honor while balancing grace and truth
- ▶ Excellence: Providing the best possible environments and ministries with the resources available
- ▶ Action: Discerning the Lord's will and moving forward in a timely manner

LIFEPARK CONNECT 101

In this class we will discuss the history of LifePark, what we believe and the value of membership.

- ▶ Welcome
- ▶ LifePark Vision & History
- ▶ What We Believe
- ▶ Value of Membership

LIFEPARK VISION

Our vision at The Church at LifePark comes from John 10:10 which says:

*"The thief comes only to steal and kill and destroy;
I have come that they may have life and have it to the full."*

We feel there are three ingredients to experiencing Life to the Full in Christ.



Knowing Christ

- personal spiritual habits
- worship services
- fasting and prayer



Growing in Relationships

- lifegroups
- serving
- care



Sharing the Gospel

- sphere of influence
- local outreach
- missions: local, national & global

WHAT WE BELIEVE

(Note: See Supplemental Information in the back of this book for Scripture References for each section)

The Bible

We believe the sixty-six books that comprise the Old and New Testaments of the Bible are the _____ (God-breathed) words of God and are the final authority for all believers in their faith and practice. All Scripture originated with God and was given through holy men who were "moved by the Holy Spirit." We believe this divine inspiration extends equally to all parts of the writings as they appeared in the original manuscripts. All Scripture is a testimony to _____, who is Himself the focus of divine revelation. We believe Scripture is able to "make you wise for salvation" and is useful for "teaching, rebuking, correcting, and training in righteousness."

God

We believe that there is one _____ and _____ God and that He is the all-knowing, all-powerful, ever-present supernatural being who created all things and has eternally existed in three persons—God the Father, God the Son and God the Holy Spirit—though He is one. This tri-unity, or Trinity, of God means that all three are _____ and possess identical attributes without confusion or loss of essence and are therefore all worthy of praise and adoration. Ultimately, God is sovereign over all His creation and is intimately involved with it.

Jesus Christ

We believe that Jesus Christ was and is the eternal second person of the Trinity. He is God's only begotten Son, conceived by the Holy Spirit, and born of Mary, a virgin. He is both fully _____ and fully _____. Though a man, He lived a sinless life of perfect obedience to the Father's will and demonstrated His power and divinity through the miracles He performed on earth. Jesus offered _____ as the perfect sacrifice for the sins of all men by dying on a cross—a sin offering which both satisfied God's justice and opened up the way for man to enter into a living and eternal relationship with God. After His literal death, Jesus experienced a bodily resurrection on the third day after his crucifixion. After a period of teaching His disciples, He ascended into heaven where He now sits at _____ of the Father and acts as our High Priest and Advocate. He will return in power and glory to judge the world and to consummate His redemptive mission.

WHAT WE BELIEVE

(continued)

The Holy Spirit

We believe that the Holy Spirit is, and always has been, fully _____ and the third person of the Trinity. He is God's _____ on earth today and works in both the lives of believers and unbelievers. As to unbelievers, He convicts them of sin, righteousness, and judgment. As to believers, He regenerates them, indwells them, sanctifies them, baptizes them into the body of Christ upon conversion, seals them as a guarantee of their salvation and empowers them to live the Christian life. In addition, He reveals truth, guides, teaches, intercedes, comforts, strengthens, distributes spiritual gifts and empowers believers for effective witness.

Man

We believe that man (generic for male and female) is a special creation of God and has been made _____. As such, every human being has great worth and value. In the beginning man was innocent of sin and endowed by his Creator the freedom of choice. By his free choice man sinned against God and brought sin into the human race. Since then, the entire human race has been _____ by nature and is therefore justly condemned by God. Alone, man is completely unable to merit salvation. Only through _____ in Christ can man obtain the righteousness that God requires and thereby establish his relationship with God. Upon death, a believer, as a disembodied soul, goes into the immediate presence of Christ and awaits the resurrection of his spiritual body. However, the unbeliever, also as a disembodied soul, enters into a conscious state of misery and awaits the final judgment, after which he will be eternally separated from God.

Salvation

We believe that the only way of salvation is through the shed blood of Christ to all who believe. This salvation does not come about because of a man's works, but because of God's _____. From the individual's perspective, this happens because he _____ (chooses to follow Christ and not himself) and places his total trust (faith) in Christ and His finished work upon the cross. Upon making this decision, the believer receives _____ and becomes a child of God. Christ's death fully pays the penalty for all of a believer's sin (past, present, and future) as God credits him with the righteousness of Christ. This whole transaction transforms the man into a new creation of God for a life of holiness and obedience.

WHAT WE BELIEVE

(continued)

The Church

We believe that the term church as used in the Scriptures refers to both the universal church and the local church. The _____ church is comprised of all believers of all time while the _____ church is a local expression of the universal church—comprised of believers who voluntarily gather together to accomplish God's work in this world. The purpose of the Church is to glorify Christ by making disciples of all nations. Christ is the _____ of the Church and, as such, guides it, directs it, holds it together, and causes it to grow. Each congregation operates under the Lordship of Christ through democratic processes. In its true form the Church is comprised of believers only—meaning that only believers are eligible for membership. The role of the members is to use their spiritual gifts to edify the body of Christ. The task of the leadership of the Church is to equip believers for works of service and to seek with all their energy to present every member complete in Christ.

Future Things

We believe that God, in His own time and in His own way, will bring the world to its appropriate end. According to His promise, Jesus Christ will return personally and visibly in glory to the earth; the dead will be raised; and Christ will judge all people in righteousness. The _____ will be consigned to Hell, the place of eternal punishment. The _____ in their resurrected and glorified bodies will receive their reward and will dwell in Heaven with the Lord forever.

The Family

We believe that God has ordained the _____ as the foundational institution of human society. It is composed of persons related to one another by marriage, blood, or adoption. Marriage is the uniting of one _____ and one _____ in covenant commitment for a lifetime. It is God's unique gift to reveal the union between Christ and His church and to provide for the man and the woman in marriage the framework for intimate companionship, the channel of sexual expression according to biblical standards, and the means for procreation of the human race. Children, from the moment of conception, are a blessing and heritage from the Lord. Parents are to demonstrate to their children _____ pattern for marriage and family life. Parents are to teach their children spiritual and moral values and to lead them, through consistent lifestyle examples and loving discipline, to make choices based on biblical truth. Children are to honor and obey their parents.

WHAT WE BELIEVE

(continued)

Baptism and The Lord's Supper

We believe that Christian baptism is the immersion of a believer in water in the name of the Father, the Son, and the Holy Spirit. It is an act of _____ symbolizing the believer's faith in Christ, death to sin, burial of the old life, and resurrection to walk in newness of life in Christ Jesus. Through examination by pastoral staff, baptism shall be administered to those who have trusted Christ as Lord and Savior. The mode shall be by immersion in water unless physical limitations exist. The Lord's Supper is a symbolic act of obedience whereby believers, through partaking of the bread and the fruit of the vine, _____ the death of the Redeemer and anticipate His second coming. It shall be observed at least quarterly or at such other times as the Senior Pastor and / or the presiding elders shall determine.

MEMBERSHIP

(excerpt from "Church Membership" by Jonathan Leeman)

What is a Church? Is it Biblical?

A local church is a group of Christians who regularly gather in Christ's name to officially affirm and oversee one another's membership in Jesus Christ and His kingdom through gospel preaching and gospel ordinances. The Scriptures instruct Christians to follow and honor the leaders of their church (Heb. 13:17, 1 Tim. 5:17).

What is a Church Member?

Church membership is a declaration of citizenship in Christ's kingdom. Church membership is all about a church taking specific responsibility for you, and you for a church. God's plan is that we would belong to local churches.

Correcting Another Believer

Church discipline is a part of the discipleship process, the part where we correct sin and point the disciple toward the better path. To be disciplined is, among other things, to be disciplined. It's referenced several times in the New Testament; for example, in 1 Corinthians 5:1-12. In this text Paul confronts the church in Corinth for approving of a man walking in blatant, unrepentant sin. The Corinthians are celebrating this as God's grace, but Paul warns them that this type of sin shouldn't make them boast, but rather mourn. Church discipline is the appropriate course of action when the character of a person's representation brings shame on Jesus' name. The underlying purpose in church discipline is love: for the individual, for the church, for the watching world, and for Christ.

REASONS MEMBERSHIP MATTERS

(excerpt from "Church Membership" by Jonathan Leeman)

It's modeled in the Bible. Jesus established the local church and all the apostles did their ministry through it. The Christian life in the New Testament is largely modeled in local church life.

The church is its members. To be "a church" in the New Testament is to be one of its members. You want to be part of the church because that's who Jesus came to rescue and reconcile to himself.

It's a way to officially represent Jesus. Membership is the church's affirmation that you are a citizen of Christ's kingdom and therefore a card-carrying Jesus Representative before the nations.

It's a way to declare one's highest allegiance. Your membership on the team is a public testimony that your highest allegiance belongs to Jesus.

It's a way to embody and experience biblical images. It's within the accountability structures of the local church that Christians live out or embody what it means to be the "body of Christ."

It's a way to serve other Christians. Membership helps you to know which Christians on planet Earth you are specifically responsible to love, serve, warn, and encourage. It enables you to fulfill your biblical responsibilities to Christ's body (for example, see Eph. 4:11-16; 25-32).

It's a way to follow Christian leaders. Membership helps you to know which Christian leaders on planet Earth you are called to obey and follow.

It helps Christian leaders lead. Membership lets Christian leaders know which Christians on Planet Earth they will "give an account" for (Acts 20:28; 1 Peter 5:2).

It enables church discipline. It gives you the biblically prescribed place to participate in the work of church discipline responsibly, wisely, and lovingly (1 Cor. 5).

It gives structure to the Christian life. It places an individual Christian's claim to "obey" and "follow" Jesus into a real-life setting where authority is actually exercised over us.

5 THINGS TO CONSIDER

(excerpt from "Church Membership" by Jonathan Leeman)

- ▶ The local church is not a club. Nor is a church a service provider where the customer has all authority. Many of us mistakenly assume that we have the authority to conduct our Christian lives on our own.
- ▶ The local church is the authority on earth that Jesus has instituted to officially affirm and give shape to our Christian lives.
- ▶ The local church is a real-life embassy, set in the present, that represents Christ's future kingdom and His coming universal church.
- ▶ A church member at LifePark is an adult who has been publicly recognized as a Christian as well as someone who shares in the authority of officially affirming and overseeing other Christians in his or her church.
- ▶ Once you choose Christ, you must choose His people too – which you do through a local church.

LIFEPARK MEMBERSHIP REQUIREMENTS

- ☒ Affirm you are a Christian who has accepted Christ as Lord and Savior, and are committed to following Him.
- ☒ Attend all four LifeParkConnect Classes in no particular order, but in a one year time frame from the time you attend your first class.
- ☒ Believers Baptism by Immersion (unless unable due to disability)
- ☒ Elder/Pastoral Conversation with one of our Elders/Pastors once you have completed the classes and have filled out the Membership Intention Form
- ☒ At least 16 years of age

LIFEPARK CONNECT 201

In this class we will discuss how you can know Christ and develop personal spiritual habits to personally connect with Him.

- ▶ Welcome
- ▶ Knowing Christ
- ▶ Spiritual Habits
- ▶ Next Steps
- ▶ Take a deeper dive into spiritual habits using the resources at churchatlifepark.org/spiritualhabits

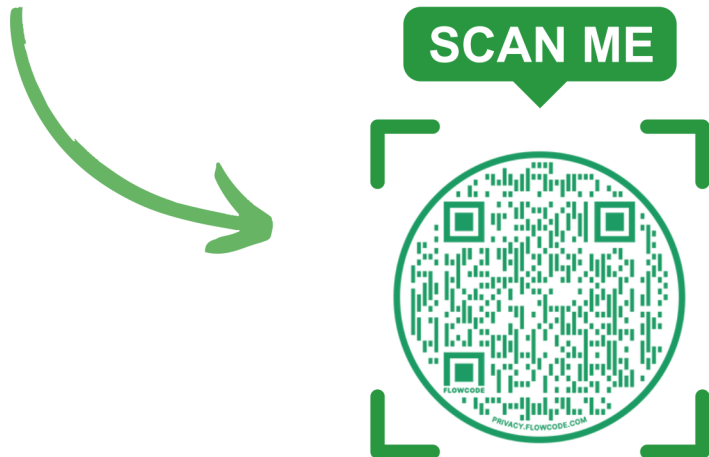

SPIRITUAL HABITS

The _____ is the good news that through personal faith in the life, death, and resurrection of Jesus Christ, a person can be forgiven of their sin, granted eternal life, and restored to a right relationship with God. Christians pursue _____ (a closer walk with God) as a response to the Gospel by practicing the spiritual habits of the faith. Any spiritual activity or habit that we do serves to help us _____ the Gospel, _____ in the Gospel, or _____ out the Gospel in our everyday lives. There are seven primary spiritual habits recommended for people at LifePark: Bible reading & meditation, prayer, worship services, giving, groups, serving, and living on mission.

1. _____ – There are many ways to do Bible reading & meditation. Meditation is simply thinking about the Scripture you just read. At LifePark, we recommend the SOAP process. SOAP stands for: Scripture, Observations, Application, and Prayer.
2. _____ – Jesus modeled dependent prayer to His Father and taught His disciples to do the same (Luke 11:1-4). At LifePark, we desire for every person to depend on the supernatural work of God to do abundantly more through consistent, Spirit-filled prayer. (Zech 4:6, Eph 3:20-21 & 6:18, James 5:16). We recommend praying scripture and using the A-C-T-S model. ACTS stands for: _____ (Praise), _____, _____, _____ (Requests).
3. _____ – There are two types of worship: Personal and Public. _____ worship characterizes the entire life of the believer. _____ worship is when believers gather together to praise God, learn from the Scriptures, pray, and build relationships.
4. _____ – Giving is a vital spiritual practice simply because money has such a prominent place in our lives. At LifePark, we encourage giving to be done on a _____ basis (automated online giving is really easy). Also, we encourage each person to be _____ and _____ with their amount of giving as an act of worship to God.

SPIRITUAL HABITS

5. _____ – Christians were created to live in community. Too often, we settle for surface level relationships. The Bible encourages believers to pursue deeper relationships with a small group of people. Groups exist to help people grow in faith through building deeper relationships centered on Jesus Christ.

6. _____ – Christians are called to be contributors to God's Kingdom. To that end, God has gifted every believer to make a difference. It is the believer's responsibility to discover how they have been gifted and to exercise the gift for the local church.

7. _____ – Sharing the Gospel – Is both a command (Matthew 28:16-20) and a privilege (2 Cor 5:20). As we grow in our knowledge and love for God, we should grow in our love for our neighbors, compelling us to share our story of redemption with them. Furthermore, scripture tells us faith comes by hearing of God's word, (Romans 10:17) so God gives us the awesome opportunity to be part of work that has eternal impact. At LifePark we want to help equip and provide opportunities for you and your family to practice sharing the gospel.

SPIRITUAL HABITS

SOAP Journal Entry Example

S: Scripture

"The LORD is my shepherd; I have all I need." (Psalms 23:1 NLT)

O: Observation

- A psalm of David. He had been a shepherd in his youth.
- A shepherd tends, leads, feeds and protects his flock.
- A shepherd cares for his flock- providing all of their needs.

A: Application

Let God be your shepherd. Allow Him to guide you, provide for you and protect you.

Yield to Him. Be satisfied and content with what God has given you.

P: Prayer

Father, You are holy. You are worthy. You provide all my needs. Forgive me for not always yielding to you, your ways and your timing. I want to take control and do things my way. Forgive me for wanting more time, more rest, more vacations and more stuff. Thank you for revealing sin to me so I can confess it to you. Remind me to trust in your plans knowing you have my best interest in mind. Replace my discontentment with a heart of gratitude and satisfaction. Father, you are enough for me. Build my faith as I yield to you more and more. It's in Your Son's name I pray. Amen.

PILLARS OF PRAYER

Community Prayer Service

First Thursday of the month evening service that equips and encourages the saints, through prayer and worship, to minister to our people and the community.

Noon Prayer Service

Weekly noon service, drop-in time of quiet, personal prayer and meditation on scripture.

Intercessory Prayer Teams

Volunteers who meet weekly for one hour to pray for the needs of the church.

Inner Healing Prayer Teams

Personal, intensive sessions (scheduled by appointment) during which prayer ministers pray for individuals seeking healing.

Prayer Cohorts

Weekly groups during which members receive instruction in the understanding of Biblical prayer, how to develop a prayer life, share prayer stories, and pray together. (Volunteer & staff led)

Sunday Corporate Prayer Moments

Monthly opportunities for congregational prayer during all of our Sunday morning worship services. (Volunteer & staff led)

Equipping Praying Churches

Investing in pastors and leaders at prayer hungry churches by providing coaching and prayer envisioning opportunities.

Scan this code to visit
our online

Prayer Wall

churchatlifepark.org/prayerwall



Prayer Wall



lifeparkconnect



LifePark Spiritual Health Plan



NAME: Noah	SPIRITUAL HABITS	RELATIONSHIPS	PHYSICAL HEALTH	STEWARDSHIP	PURPOSE \ MISSION	OTHER
DAILY	spend 20 mins reading my Bible & praying	encourage my wife and kids; have a family devotion	stretch	pick up around the house	pray for God to use me to advance His Kingdom	
WEEKLY	attend a worship service & LifeGroup	work on memorizing a Bible verse as a family	go to the gym 3 times	review finances clean the house	share the gospel/how God has blessed me with someone	rest from work – choose to focus on delighting in God
MONTHLY	attend the 1st Thursday Prayer Service	call my parents /grandparents go on a date with my spouse	go for a run	give to LifePark and other charities	serve in the church or the community	invite friends over for dinner
QUARTERLY	take a morning/ evening to walk and pray	do something fun with the kids	take a morning/ evening to walk and pray	donate items I don't need	take a morning/ evening to walk and pray	fast for one day – allowing only one meal
ANNUALLY	go on the men's hike	vacation	go on the men's hike		go on a mission trip	

INSTRUCTIONS

1. Do not panic! This spiritual health plan is designed to help you, not define you. Only the gospel of Jesus Christ defines you and gives you hope.
2. Pray and ask the Lord to help you build a spiritual health plan.
3. Think about each category along the top row and what specific task you could assign.
4. Repeat Step 1.

TIPS

- Be sure to take it slow and start small. Small steps done consistently will produce better growth than large steps done infrequently.
- Try to work in the following spiritual disciplines: Bible reading & meditation, Bible memorization, prayer, confession, fasting, Sabbath rest, simplicity, worship, silence & solitude, and service.
- It is OK to leave a space blank and to put the same item in two relevant spaces.
- For more information, visit churchatlifepark.org/spiritualhabits





LifePark Spiritual Health Plan



NAME:	SPIRITUAL HABITS	RELATIONSHIPS	PHYSICAL HEALTH	STEWARDSHIP	PURPOSE \ MISSION	OTHER
DAILY						
WEEKLY						
MONTHLY						
QUARTERLY						
ANNUALLY						

INSTRUCTIONS

1. Do not panic! This spiritual health plan is designed to help you, not define you. Only the gospel of Jesus Christ defines you and gives you hope.
2. Pray and ask the Lord to help you build a spiritual health plan.
3. Think about each category along the top row and what specific task you could assign.
4. Repeat Step 1.

TIPS

- Be sure to take it slow and start small. Small steps done consistently will produce better growth than large steps done infrequently.
- Try to work in the following spiritual disciplines: Bible reading & meditation, Bible memorization, prayer, confession, fasting, Sabbath rest, simplicity, worship, silence & solitude, and service.
- It's OK to leave a space blank and to put the same item in two relevant spaces.
- For more information, visit churchatlifepark.org/spiritualhabits

LIFEPARK CONNECT 301

In this class we will discuss how children and adults are growing in relationships with other believers and how you can receive care at LifePark.

- ▶ Welcome
- ▶ Student Life
- ▶ Group Life
- ▶ Care Ministry
- ▶ Next Steps
 - Find your group: lifeparkgroups.org
 - Need care? Visit churchatlifepark.org/care

**Find
your
group**



SCAN ME



PATHWAYS TO CONNECTION

LifeGroups

LifeGroups are about Christ-centered relationships that help us grow spiritually. They are the primary way to get more connected at LifePark. Each week, groups gather throughout neighborhoods in our city and at our church for Bible study, fellowship, prayer, and mission. It's our desire at LifePark to see every adult connected to the church in LifeGroups.

Classes

Classes exist to raise the value of Biblical and Theological literacy in order to deepen faith and strengthen ministry environments. Classes are lecture based with some discussion, consist of 15-50 people, and focused on building knowledge.

Care Groups

Care groups are weekly, friendly, and caring groups of people who will walk alongside you through life's most difficult experiences. We offer a variety of care groups such as: DivorceCare (help and healing for the hurt of separation or divorce) and GriefShare (a support group for those grieving the loss of a loved one) as well as Recovery groups (for men who are struggling with negative habits and want the power of the gospel and biblical, life-giving community to heal).

Re|engage

Re|engage is a weekly marriage enrichment ministry comprised of 2 essential parts: Large Group and Small Groups. Large Group is a time of inspiration and encouragement where leaders share how God has brought healing to their marriages. Small Groups create an environment for couples to build relationships with other couples while working on their own personal and relational growth. Re|engage runs only in the fall (Sept-Dec).

PATHWAYS TO CONNECTION

(continued)

Mentoring Groups

Mentoring at LifePark provides specific spiritual and practical insight and wisdom into a person's life from an experienced leader. Mentoring at LifePark takes place in 2 ways: Mentoring Groups (Radical Mentoring for women and Radical Mentoring for men) and One on One mentoring.

Prayer Cohorts

One of the main ways we can know Christ and grow up in Him is through prayer. Prayer is essential because it is how we listen and speak to our Heavenly Father. Most agree that prayer is important but many of us find it challenging. Cohorts are groups of people who meet weekly to help each other learn to pray. We also discover the joy of praying together and watching God move in each other's lives.

Men's & Women's Hikes

The LifePark Hike is an opportunity for men and women to get away from the busyness of life and go on a four-day adventure exploring God's creation. This is a great chance for you to hike, camp, build relationships with other men or women, and experience God. Hike opportunities are typically offered for men and women in the Fall and in the Spring.

LIFEPARK CONNECT 401

In this class we will discuss how you can connect with others through serving and sharing the gospel.

- Welcome
- Serving at LifePark
- Sharing the Gospel
- Next Steps - churchatlifepark.org/401form

Scan this code to explore
Missions & Serving
at LifePark



SCAN ME



SCAN ME



Ready to apply for Membership?

Scan this code to complete a membership intent form. Once submitted, we will connect you with one of our elders (or a pastor) for a membership interview.



Scan this code to start serving
churchatlifepark.org/serve

SCAN ME



SERVING OPPORTUNITIES

Noah's Park (Birth-4K)

- Greeters/Check-In- Welcome first-time families and help with check-in.
- Leaders- Recap the Bible story from large group and facilitate crafts.
- Volunteer Hospitality- Provide breakfast for Noah's Park volunteers on Sunday.
- Mid-Week Administration- Cutting, copying, organizing materials for Sunday morning.
- Childcare (Paid)- Weekdays and weeknights (not Sunday morning)

KidsPark (Kindergarten- 5th Grade)

- Greeters/Check-In- Welcome first-time families and help with check-in.
- Group Leader- Recap the Bible story from large group and facilitate activities.
- Assistant Group Leader- Help the Group Leader with their responsibilities and children.
- Mid-Week Administration- Cutting, copying, organizing materials for Sunday morning.

WonderPark

Buddy- Helping with our "fearfully & wonderfully made" children as a buddy (special needs ministry)

FirstWave (Middle/High School Students)

- High School Group Leader- Build relationships & help co-lead small group Bible Studies for High School students on Wednesday nights at LifePark.
- Middle School Group Leader- Build relationships, hang out and co-lead a Bible study on Wednesday nights for a group of 8-12 middle school students.
- Pancake Team- Greet & serve pancakes to students for the 10 AM and/or 11:30 AM Sunday services. (1-2x/month)
- Greeters/Check-In- Welcome first-time families and help with computer check-in.

SERVING OPPORTUNITIES

Worship Ministry

- Production/Media- Run production/media elements for worship services (Audio, Video, Lighting, Computer Projection). Training is available.
- Worship Team- Share your vocal and/or instrumental gifts with the congregation during worship services. Evaluation required.

Prayer Team

- Thursday Noon Prayer Greeter- Provide a warm welcome and answer guests' questions about service. (Bi-Weekly)
- Thursday Evening Ushers- Greet and direct guests to open seats before/during service. (Monthly)
- Thursday Evening Greeters- Friendly face who welcomes guests with a hello and a smile. (Monthly)
- Thursday Evening Prayer Minister- Prays for individual needs during the evening prayer service. (Monthly)
- Weekly Prayer Team- Meet to pray for the prayer requests of the church. (Weekly)

Host Ministry

- Greeting Team- Friendly face who welcome guests with a hello and a smile.
- Worship Greeters- Smiling presence who guide guests into the Worship Centers.
- The Well (Café Team)- Greet guests at The Well. Ensure The Well is welcoming to everyone, clean and well stocked with accouterments.
- Parking Team- Help direct traffic in the parking lot or run golf cart shuttles.
- Safety/Medical Team- Help with security OR help with medical issues that arise.
- Ushers (Worship Services)- Provide support in worship services (seating, offering, communion).

SERVING OPPORTUNITIES

Next Steps Ministry

Encouraging person ready to engage & connect with guests, answer questions about the life of the church, and assist them in taking their next steps.

Facility Team

- Indoor- cleaning, maintenance, sanctuary chair set up, repairs, painting
- Outdoor- walkthrough of grounds to identify needs, repairs, painting, Sunday morning leaf blowing

Communications Team

Capturing photos and videos during events and services.

Adult Discipleship

- LifeGroup Leader - Lead a group of people to grow relationally and spiritually through organizing group meetings, facilitating discussion, and shepherding group members.
- Class Leader - Organize and teach a group of adults in a regular class setting. A class leader is responsible for preparing and teaching biblically sound material and communicating with class members.
- Re|Engage Leader - Leads a group of married adults through the Re|Engage curriculum. This entails facilitating discussion at weekly meetings, and shepherding adults.
- Care Group Leader - Lead a group of adults on a weekly basis through a guided curriculum (DivorceCare, GriefShare, Addiction/Recovery). Organize group meetings, facilitate discussion, and shepherd people.
- Radical Mentor - Mentor a group of adults on a 9-month journey through our mentoring curriculum.
- 1:1 Mentor - Partner with one person seeking a mentor to shepherd them spiritually through a short season with a focused emphasis on targeted growth.

Sharing the Gospel

Missions

Local, Regional, Global



Our Model

We partner with church plants here in the Lowcountry, throughout the US, and around the globe to see Gospel-centered churches planted in communities with less than 5% evangelical presence. We work primarily with the North American Mission Board and International Mission Board.

Our Partners



South Carolina

We've helped plant 4 churches in the Charleston Area



Maryland

We partner with a church plant in Baltimore called Church of the Harbor



Pennsylvania

We partner with a church plant in Pittsburgh called Steel City Church



Puerto Rico

We partner with a church plant outside of San Juan called Eternal Hope Baptist Church



Guatemala

We partner with a IMB team in Antigua, Guatemala

Mission Trips

We offer trips throughout the year to **all of our partners!** The dates for the trips change each year, but we work to communicate **all** of our mission trip opportunities for the upcoming year as early as November before the new year! Here's some trips you can **count on**:

1. Family Spring Break Trip - **every CCSD Spring Break**
2. International Trips - **at least two a summer**



Sharing the Gospel

Local Outreach Partners

1. **Charleston Seafarers** - serves the thousands of seafarers that visit our port each year. Generally, cargo crews are made up of men from SE Asia. The Seafarers serve crews by providing hygienic items, internet to call home, and fellowship while in port.
2. **Carolina Youth Development Center** - serves foster care and at-risk children through a foster home and after school programs. Carolina Youth Development Center works to empower and equip at-risk children with educational support and career readiness as they navigate life.
3. **East Cooper Community Outreach** - serves over 900 families East of the Cooper in various ways targeting poverty relief. They offer medical and dental services, job development, a food bank, a clothing bank, and so much more.
4. **East Cooper Meals on Wheels** - serves hundreds of families in our own backyard by providing nutritional meals to individuals who are homebound for any period of time.
5. **Feeding the Hungry** - serves local homeless individuals downtown. We partner with the Navigation Center to provide hot meals and fellowship to those we serve.
6. **Good News Bible Clubs** - are after-school clubs within local elementary schools that provide a chance for children to hear the Gospel. This is a great opportunity to reach and disciple the next generation
7. **Hope to Home** - serves individuals and families experiencing either a transitional housing situation or housing instability. H2H serves its clients by providing basic furniture that makes a house feel like a home.
8. **Lowcountry Pregnancy Center** - serves young mothers who are unexpectedly expecting a child. LPC serves these women by offering pregnancy services, counseling, and parenting resources.
9. **Shield ministries** - helps men who have been released from a correctional facility navigate re-entry into society through a faith-based program. They offer housing, job placement, personal and spiritual development, and so much more.
10. **Windwood Farms** - serves young boys who have been separated from their families due to abuse, neglect, or other family issues. Windwood Farms provide psychiatric, behavioral, emotional, and recreational therapy to the boys that call the farm home before they enter into a large group home or foster care family.



1st Saturday & 3rd Thursday - ECCO
 2nd Saturday - Hope to Home
 3rd Thursday - Feed the Hungry
 2nd & 4th Sunday - Windwood Farm

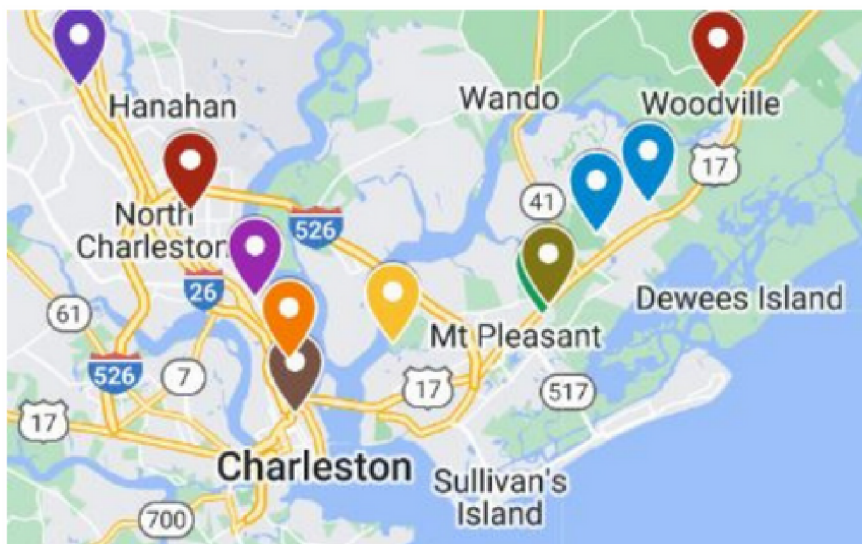

Sharing the Gospel

Sphere of Influence

All of us find ourselves in several different places each week: work, the carpool line, kid's sports practice, the neighborhood pool, a golf course, a favorite restaurant, etc. This is your sphere of influence. We've identified two books that can help equip you to share the Gospel with those you come in contact with. This is a great starting point if you haven't ever shared the Gospel, or just need a refresher.



Here is a great resource to learn how to get to know your neighbor.

Here is a great resource to learn how to share your faith.

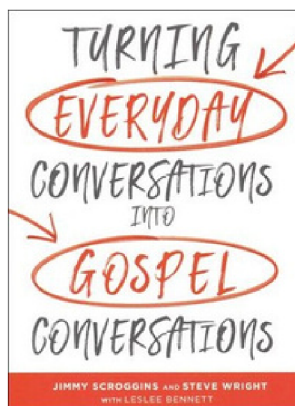

LifePark has also developed a 3-part study to help you understand the biblical foundations for evangelism, how to share the Gospel, and how to discern where to share the Gospel! You can do it alone or with a group. Scan here to find both leader guides and group handouts.



ORGANIZATIONAL STRUCTURE

The Church at LifePark is a congregation ruled, elder led church. This means that the members of the church decide the biggest decisions of the church democratically and select elders who will oversee all other matters. The church holds an annual business meeting in June every year to review and discuss the previous year's budget and ministry imperatives as well as the next year's budget and ministry imperatives. During this time, members of the church nominate and vote on elders to lead the church and deacons to serve certain needs of the church.

The elders are responsible for setting the vision and structure of the church. They determine the church's vision statement, generate annual ministry imperatives in conjunction with the senior leadership team, approve ministry staff positions, shepherd senior staff, and carry out church discipline. Deacons serve primarily in care ministry through benevolence as well as organizing to help church members in need. Church staff are responsible for organizing ministries, recruiting and empowering volunteer leaders, and carrying out the imperatives of the elders. The staff team is led by the senior leadership team which consults with, guides, and submits to the elder board.

The Church at LifePark is affiliated with the Southern Baptist Convention and actively participates in the ministries of the South Carolina Baptist State Convention as well as the local Charleston Baptist Association.

Meet our Elders



Kenny Caldwell



Jeremy Ellisor



Dale Good



Chad Moore



Paul Nodtvedt



Matt Pinkel



Rick Redden



Chris Whitaker



Robert Keller
not pictured

You can contact the elders at elders@lifeparkmp.org

Meet our Staff



Chad Moore

Lead Pastor



Rogers Hook

Missions & Evangelism



Steve Holt

Worship



Rick Higgins

Care



Noah Reid

Discipleship



Tom Meara

Student Ministry



Mike Gaskins

Children's Ministry



Kelley Shaw

Preschool Ministry



Shea Burdette

Special Needs Ministry



Amanda Denton

Student Ministry



McLeod Best

Student Ministry



Gen Gibson

Host Ministry



Kim Perritt

Next Steps



Aidan Chavez

Worship



Brandy Botto

Administration



Anna Haysom

Adult Discipleship



Jeremy Dixon

Worship



Jennifer Pearce

Communications



Kaylan Freier

Worship



Faith Willard

Children's Ministry



Janice Ketner

Administration



Lindsey Zito

Student Ministry



Blake Young

Production



Tom Mallon

Facilities



Dr. William Librizzi

Care

*Living Life
To The Full*

MINISTRY OVERVIEWS



ADULT DISCIPLESHIP

Vision

We see a place for every person within a group at LifePark. We see these groups as helping people to know and love God, to build healthy relationships, to make wise decisions, and to build God's Kingdom.

Purpose

Adult Discipleship groups exist to help people become fully mature followers of Jesus Christ.

Environments

LifeGroups are about Christ-centered relationships that help us grow spiritually. They are the primary way to get more connected at LifePark. Each week, groups gather throughout neighborhoods in our city and at our church for Bible study, fellowship, prayer, and mission. It's our desire at LifePark to see every adult connected to the church in LifeGroups.

Classes exist to raise the value of Biblical and Theological literacy in order to deepen faith and strengthen ministry environments. Classes are lecture based with some discussion, consist of 15-50 people, and focused on building knowledge.

Care groups are weekly, friendly, and caring groups of people who will walk alongside you through life's most difficult experiences. We offer a variety of care groups such as: DivorceCare (help and healing for the hurt of separation or divorce) and GriefShare (a support group for those grieving the loss of a loved one) as well as Recovery groups (for men who are struggling with negative habits and want the power of the gospel and biblical, life-giving community to heal).

Re|engage is a weekly marriage enrichment ministry comprised of 2 essential parts: Large Group and Small Groups. Large Group is a time of inspiration and encouragement where leaders share how God has brought healing to their marriages. Small Groups create an environment for couples to build relationships with other couples while working on their own personal and relational growth. Re|engage is offered in the fall (Sept-Dec).

Mentoring at LifePark provides specific spiritual and practical insight and wisdom into a person's life from an experienced leader. Mentoring at LifePark takes place in 2 ways: Mentoring Groups (Radical Mentoring for women and Radical Mentoring for men) and One on One mentoring.

Men's/Women's Hikes are an opportunity for men and women to get away from the busyness of life and go on a four-day adventure exploring God's creation. This is a great chance for you to hike, camp, build relationships with other men or women, and experience God. Hike opportunities are typically offered for men and women in the Fall and in the Spring.

CARE MINISTRY

Vision

Our vision may be summarized by Galatians 6:10, "So then, while we have opportunity, let's do good to all people, and especially to those who are of the household of the faith."

Purpose

The purpose of the LifePark Care Ministry is to come alongside those in need and provide support, encouragement, and perspective in times of need, such as a loss of job, major illness, divorce, loss of a loved one, or other life crisis.

Environments

Our care ministry has three primary levels of care:

Basic care involves a minor disruption of life for a brief duration; this may include a minor illness, loss of transportation, basic home maintenance, etc.

Intermediate care involves ongoing, structured support. This often involves ongoing counseling and support; examples are pre-marital counseling, ongoing counseling, Divorce Care, Grief Share, etc.

Crisis care involves a major disruption of life for an extended period of time. This involves divorce, death, and spiritual warfare issues.

CHILDREN'S MINISTRY

Vision

KidsPark, LifePark's children's ministry, partners with parents in leading children to live life to the full through knowing Christ, growing in relationships and sharing the gospel

Purpose

KidsPark exists to impart God's truths to children as we help lead them into a relationship with Jesus Christ.

Environments

Kid's Park meets at 8:30, 10:00 and 11:30 each Sunday morning in the East Building.

The LightHouse - Kindergarten & 1st Grade

The Beach House - 2nd & 3rd Grade

The Pier - 4th and 5th Grade

Curriculum - The Gospel Project for Kids (the entire Bible [OT & NT] is taught in 3-year cycles).

STUDENT MINISTRY

Vision

FirstWave, LifePark's middle and high school student ministry, exist to help students live life to the full through Knowing Christ, Growing in Relationships, and Sharing the Gospel.

Purpose

FirstWave Student Ministry exists to give students in grades 6-12 a place to connect with God and others and be transformed with the life-changing message of Jesus.

Environments

Middle School Ministry

Sunday Morning // 10am OR 11:30am in LifePark West

Wednesday Nights // Decipher // 6:00-7:30pm in LifePark East

High School Ministry

Sunday Mornings // 11:30am in LifePark West

Wednesday Nights // Small Groups 6:00 – 7:30pm in LifePark West

HOST MINISTRY

Vision

Our team exists to create an exceptional experience for our guests and members to gather together and worship the Lord.

Purpose

From the time guests and members pull into the parking lot until they enter the specific ministry area of their choice, Host Ministry Teams seek to offer an element of excellence across all environments: both in physical appearance of our building and grounds, as well as with joy-filled, relational, energetic volunteers.

Environments

Parking - The purpose of the Parking Team is to make the environment accessible to our guests with the least effort possible.

Greeters - The purpose of the Greeters is to invite guests into the environment where they can experience and share the love of Jesus.

Worship Ushers - The purpose of the Worship Ushers is to set the spiritual climate and arrange seating of the guests within the environment.

The Well - The purpose of the Well is to create an environment for our guests to connect with one another and be refreshed outside of worship service.

Safety - The purpose of the Safety Team is to maintain a secure environment for worship.

Medical - The purpose of the Medical Team is to provide medical attention and, when required, emergency care to the environment.

MISSIONS & EVANGELISM

Vision

The vision for missions and evangelism is to lead the congregation to know God, understand the call to missions, and share the Gospel.

Purpose

LifePark Missions and Evangelism exists to:

- EQUIP the congregation with tools and skills that help them share the Gospel.
- EMPOWER the congregation to see their sphere of influence, community, and world as an opportunity to share the Gospel.
- ENCOURAGE the congregation to take their next steps in engaging the lost through one of our ministry areas.

Environments

We accomplish both the vision and purpose of our ministry by offering several “on-ramps” for the congregation to find their fit in one of our ministry areas. These “on-ramps” allow the congregation to test the waters of their calling, to get equipped with missional skills, and to be sent out to do the work of ministry.

- Sphere of influence - Family, Friends, Co-workers, Neighbors, etc
- Local Outreach - Multiple partners & Love Local events each year
- Missions - Domestic and International Trips

NEXT STEPS

Vision

The vision of the Next Steps Ministry is to connect and engage with members and guests while encouraging them to take their next step on their spiritual journey. "The heart of man plans his way, but the Lord establishes his steps." Proverbs 16:9

Purpose

The purpose of the Next Steps Ministry is to connect people to the church, its ministries, and programs that drive the mission of LifePark... helping people Live Life to the Full through Knowing Christ, Growing in Relationships, and Sharing the Gospel. The Next Steps Ministry connects and engages people through conversations, introduction to first-time guests, answering questions, signing up for an event, connecting to a serving team, LifeGroup, LifeParkConnect Classes, or through prayer. Everyone has a next step to take!

Environments

Next Steps - A place to get your questions answered, connect with other LifeParkers and sign up to get connected to other ministries like LifeGroups and serving.

LifeParkConnect - Whether you are a newcomer or longtime LifeParker, our LifeParkConnect classes are designed for you. The classes are part of our membership process, but they are also for anyone looking to connect and engage at a deeper level. If you want to learn more about our vision, beliefs and opportunities to serve and grow, we invite you to jump in.

Elders on Call - Available after each service on Sunday to pray with you, encourage you and/or lead you to a relationship with Christ.

PRAYER MINISTRY

Vision

We see every person depending on the supernatural work of God to do abundantly more through consistent, Spirit-filled prayer. (Zechariah 4:6, Ephesians 3:20-21 & 6:18, James 5:16)

Purpose

To help awaken, equip, and empower the church to fully embrace dependent prayer as the conduit for unleashing the power and presence of Jesus Christ. (Ephesians 3:14-21)

Environments

1. Community Prayer Service: First Thursday of the month evening service that equips and encourages the saints, through prayer and worship, to minister to our people and the community.
2. Noon Prayer Service: Weekly noon service, drop-in time of quiet, personal prayer and meditation on scripture.
3. Intercessory Prayer Teams: Volunteers who meet weekly for one hour to pray for the needs of the church.
4. Inner Healing Prayer Teams: Personal, intensive sessions (scheduled by appointment) during which prayer ministers pray for individuals seeking healing.
5. Prayer Cohorts: Weekly groups during which members receive instruction in the understanding of Biblical prayer, how to develop a prayer life, share prayer stories, and pray together. (Volunteer & staff led)
6. Sunday Corporate Prayer Moments: Monthly opportunities for congregational prayer during all of our Sunday morning worship services. (Volunteer & staff led)
7. Equipping Praying Churches: Investing in pastors and leaders at prayer hungry churches by providing coaching and prayer envisioning opportunities.

PRESCHOOL MINISTRY

Vision

Our preschool ministry, Noah's Park, is a place for every child, age birth-4K, to know that God made them, God loves them, and Jesus wants to be their friend forever. We see a partnership between parents, leaders, and the church to disciple these littles to make a lasting impression of our Heavenly Father on the hearts of the children.

Purpose

Noah's Park exists to introduce children to the love of Jesus and foster a love of leading and serving.

Environments

Sunday Services - Sunday mornings in the East Building at 8:30, 10:00 and 11:30 Noah's Park has the opportunity to share God's free gift of salvation.

Through Mothers of Preschoolers, we gather and support moms. We believe in the simple but revolutionary idea that remarkable things happen when moms come together, face to face. That's why we rally women to come together in their own neighborhoods and help each other through motherhood, one gathering at a time. MOPs meets 2 times per month on Wednesdays.

Childcare is an extension of Adult Discipleship offered through Noah's Park for children birth - 5th grade. Childcare is offered on Tuesday evenings and Thursday mornings. This runs alongside LifeGroups, classes, and Re|engage that meet at the church.

Vacation Bible School is one of the most strategic outreach tools for the church and includes an age-appropriate evangelism emphasis. VBS provides sound, relevant Bible study that enables people to experience and respond to the gospel message in ways that are appropriate for them. Everything that happens during a day of VBS grows out of the biblical content and emphasis of that day. VBS is an entry point to church and Christianity for many people, so it must be comfortable, enjoyable, and appealing.

We exist to equip, assist, encourage, and "come alongside" parents. We want to see a Faith at Home Ministry with our children and parents. We encourage this by creating and distributing tools for parents to extend Sunday mornings at home.

REFUGE MINISTRY

Vision

The vision of the Refuge ministry is to come alongside those in need and provide material and spiritual assistance.

Purpose

The purpose of the Refuge Ministry is to assist our neighbors in severe need that is beyond their ability to resolve. We help them achieve sufficient basic safety or stability and provide access to resources that help them transition from need to knowing and serving Christ faithfully.

Environments

We assist people in our sphere of influence whom God brings across our path or into our lives as a Church.

We assist people facing significant needs that may be caused by an emergency, major disaster, injustice, or other situation warranting Church assistance.

We assist people needing basic safety or stability in their lives

If the individuals are accepted into the Refuge Ministry, they will be assigned to an appropriate spiritual advisor(s). Accountability is established through their spiritual advisor(s), who are the connection between the individual and the Refuge Ministry members.

SENIOR ADULTS MINISTRY

Vision

The vision of the senior-adult ministry is to create an environment of encouragement and edification for our senior adults. We also seek to invite those who do not have a church family to join us for our activities.

Purpose

The purpose of this ministry is to create an environment for fellowship, edification, and ministry opportunities for senior adults.

Environments

Fellowship - We conduct four large group gatherings that are complemented by more frequent small group gatherings with a specific interest. The large group gatherings provide an opportunity to meet people from other services. The times of fellowship are opportunities to reach out to people who do not have a church family.

Edification - This is an opportunity to address biblical principles and topics that are relevant to senior adults.

Ministry opportunities - Seniors have the benefit of wisdom and time and can provide support and wisdom to our existing ministries.

SPECIAL NEEDS MINISTRY

Vision

WonderPark, LifePark's special needs ministry, is here to help lead families and individuals with unique needs into a growing relationship with Jesus Christ. At LifePark, we believe this will be accomplished through inclusion of individuals with special needs and families so that there is an acceptable church environment for families impacted by special needs or disabilities. We want our kids and families to know that they are "fearfully and wonderfully made."

Purpose

WonderPark is a safe and nurturing environment where the love of Christ is made known by our Special Needs Coordinator and trained volunteers within the special needs community here at LifePark. Parents may attend church having the assurance that their children are secure and being taught biblical principles.

Environments

The church will provide a buddy to accompany WonderKid. The WonderPark room will be a setting where the assigned adult volunteer, middle or high school volunteer, and child can participate together doing alternate activities as well as a modified Bible lesson, singing and praying. The structure of this classroom will be individualized to meet the needs of the child. The child will have two buddies if it is deemed necessary to use the self-contained setting.

WORSHIP MINISTRY

Vision

The vision for corporate worship is to lead the congregation to worship God, know Him, and praise Him for His greatness, love and transforming power. We aspire that our worship services be:

- filled with the gospel message
- deliberately congregational and participatory
- celebrate the best of classic and modern music
- multi-ethnic and multigenerational

Purpose

LifePark Worship exists to facilitate biblical and relevant worship experiences that:

- ENGAGE the heart of every worshiper from every generation
- ENCOURAGE the body of Christ
- ENCOUNTER the power and presence of God
- EQUIP worshippers to impact the world around them

Environments

Sunday Morning Worship – our weekly opportunity to gather as the body of Christ on the Lord's Day to glorify God, edify believers and evangelize unbelievers.

Community Prayer Service – first Thursday of the month evening service that equips and encourages the saints through prayer and worship to minister to our people and the community.

Worship Choir – a periodic opportunity for those who enjoy singing in a group to lead our church family in worship.

Kids Praise Music Camp – a fun-filled week for children with singing, games and growing in the Lord, where the kids learn and perform an entire Gospel-centered musical.

LEAD Youth Worship Conference – a yearly conference hosted by our church that is focused on raising up and equipping the next generation of student leaders who feel the Lord's calling on their lives to pursue worship ministry.

*Living Life
To The Full*

SUPPLEMENTAL INFORMATION



SPIRITUAL GIFTS & MINISTRIES

The following is a resource for the application of spiritual gifts through the serving opportunities of LifePark's ministries based on information provided by <https://spiritualgiftstest.com/spiritual-gifts/>.

ADMINISTRATION

The gift of administration is the God-given ability to organize, direct, supervise, and implement plans to lead others toward accomplishing the goals set before them. (Luke 14:28-30; Acts 6:1-7; I Corinthians 12:28)

Where to serve: Facilities, Parking, Production, Noah's Park Check-in, Noah's Park Mid-week Administration, KidsPark Check-in, The Well, Next Steps, Communication

APOSTLESHIP

The gift of apostleship is the God-given ability to plant new ministries and churches, go into places/cultures where the Gospel is not preached, and raise up new leaders to go forth and evangelize.

(Acts 1:21-22; 1 Corinthians 12:28; 2 Corinthians 12:12; Galatians 2:7-10, Ephesians 4:11-14)

Where to serve: Missions, Adult Discipleship

DISCERNMENT

The gift of discernment is the God-given ability to clearly recognize and distinguish between the influence of God, Satan, the world, and the flesh in a given situation.

(Matthew 16:21-23; Acts 5:3-6; 16:16-18; I Corinthians 12:10; 1 John 4:1)

Where to serve: Middle and High School Group Leadership, Prayer Ministers, Weekly Prayer Team, Noah's Park Leadership, KidsPark Leadership, Adult Discipleship

SPIRITUAL GIFTS & MINISTRIES

EVANGELISM

The gift of evangelism is the God-given ability to clearly and effectively communicate the Gospel of Jesus Christ to others.

(Matthew 28:18-20; Acts 8:5-12, 26-40, 21:8; Ephesians 4:11)

Where to serve: Refuge Ministry, Missions, Prayer, Noah's Park Leadership, KidsPark Leadership, Firstwave Leadership, Adult Discipleship

EXHORTATION

The gift of exhortation is the God-given ability to strengthen and encourage those who are wavering in their faith through Biblical Truth.

(Acts 11:23-24; 14:21-22; 15:32; Romans 12:8; 1 Timothy 4:13; Hebrews 10:24-25)

Where to serve: Worship, Thursday Prayer Greeters and Ushers, Next Steps, Adult Discipleship

FAITH

The gift of faith is the God-given ability to firmly believe and confidently hope in the power of God to accomplish His will and purposes in every circumstance of life.

(Acts 11:22-24; Romans 4:18-21; 1 Corinthians 12:9; Hebrews 11)

Where to serve: Prayer Ministers, Weekly Prayer Team, WonderPark, Next Steps

GIVING

The gift of giving is the God-given ability to meet the various needs of the church and its ministries, missionaries, or people who do not have the means to provide fully for themselves.

(Romans 12:8, 13, 2 Corinthians 8:1-5; 9:6-15; Acts 4:32-37, Galatians 4:15, Philippians 4:10-18)

Where to serve: Refuge Ministry, Well Cafe Team, Noah's Park Volunteer Hospitality, FirstWave Pancake Team, Greeters, Ushers, Parking Team, Facilities Team

SPIRITUAL GIFTS & MINISTRIES

HEALING

The gift of healing is the God-given ability to pray over, lay-on hands, and exhibit great faith for those who are sick and in need of healing.

(Acts 3:1-10, 9:32-35, 28:7-10; 1 Corinthians 12:9, 28, 30, James 5:13-16)

Where to serve: Safety/Medical Team, Prayer Ministers, Weekly Prayer Team

HOSPITALITY

The gift of hospitality is the God-given ability to create a welcoming environment that displays the love of Christ.

(Acts 16:14-15; Romans 12:13, 16:23; Hebrews 13:1-2; 1 Peter 4:9)

Where to serve: Host Ministry, Next Steps, Facilities, FirstWave Pancake Team, Noah's Park Greeters, Noah's Park Check-in, Noah's Park Volunteer Hospitality, KidsPark Greeters, KidsPark Check-in, Adult Discipleship

KNOWLEDGE

The gift of knowledge is the God-given ability to effectively communicate a deep understanding of Scripture as it relates to different situations in all aspects of life.

(1 Corinthians 12:8, Romans 15:14, 2 Corinthians 2:14)

Where to serve: FirstWave Middle School and High School Group Leadership, Noah's Park Group Leadership, KidsPark Group Leadership, Adult Discipleship

LEADERSHIP

The gift of leadership is the God-given ability to care for God's people and direct them to a deeper relationship with Christ and each other.

(Romans 12:8; 1 Thessalonians 5:12; 1 Timothy 3:4-5, 12; 5:17)

Where to serve: FirstWave Middle School and High School Group Leadership, Noah's Park Group Leadership, KidsPark Group Leadership, Adult Discipleship, Next Steps

MERCY

The gift of mercy is the God-given ability to walk alongside those who are in periods of suffering and spiritually guide them in their healing process.

(Romans 12:15; 12:8; Galatians 6:2; Matthew 5:7; Luke 10:30-37; James 3:17; Jude 22-23)

Where to serve: Prayer Ministers, Weekly Prayer Team, Missions, WonderPark

SPIRITUAL GIFTS & MINISTRIES

PROPHECY

The gift of prophecy is the God-given ability to boldly deliver and interpret doctrinal truth to the people of God for the edification of the church.

(Romans 12:6; 1 Corinthians 12:10; 14:1-5, 24-26, 29-33; Ephesians 4:11-12; 1 Peter 4:10-11; 1 Thessalonians 5:20-21; 1 John 4:1-3)

Where to serve: Prayer Ministers, Weekly Prayer Team, Missions, Adult Discipleship

SERVICE

The gift of service is the God-given ability to complete tasks that free up others to use their gifts to the fullest.

(Matthew 20:25-28; Mark 10:42-45; Romans 12:7; 1 Corinthians 12:4-7, 28; 16:15-16; Acts 20:35; 6:1-7; 2 Timothy 4:11; Revelation 2:19)

Where to serve: Host Ministry, Noah's Park Childcare, WonderPark, Noah's Park Mid-Week Administration, Production, FirstWave Pancake Team, Facilities, Thursday Prayer Greeters and Ushers, Next Steps, Communication

TEACHING

The gift of teaching is the God-given ability to study the Word of God and accurately communicate applications of Scripture for other Christians.

(Ephesians 4:11; 1 Corinthians 12:28; Romans 12:7; James 3:1)

Where to serve: FirstWave Middle and High School Group Leadership, Noah's Park Group Leadership, KidsPark Group Leadership, Adult Discipleship, Missions

WISDOM

The gift of wisdom is the God-given ability to speak into a specific situation with a righteous, Biblical perspective in order to guide others towards holiness.

(1 Corinthians 1:17-31, 2:1-16, 12:8; Colossians 1:9-10, 2:1-3; James 3:13-18)

Where to serve: FirstWave Middle and High School Group Leadership, Noah's Park Group Leadership, KidsPark Group Leadership, Adult Discipleship, Missions

SCRIPTURAL REFERENCES FOR BELIEFS

THE BIBLE

Exodus 24:4; Deuteronomy 4:1-2; 17:19; Joshua 8:34; Psalms 19:7-10; 119:11,89,105,140; Isaiah 34:16; 40:8; Jeremiah 15:16; 36:1-32; Matthew 5:17-18; 22:29; Luke 21:33; 24:44-46; John 5:39; 16:13-15; 17:17; Acts 2:16ff.; 17:11; Romans 15:4; 16:25-26; 2 Timothy 3:15-17; Hebrews 1:1-2; 4:12; 1 Peter 1:25; 2 Peter 1:19-21.

GOD

Genesis 1:1; 2:7; Exodus 3:14; 6:2-3; 15:11ff.; 20:1ff.; Leviticus 22:2; Deuteronomy 6:4; 32:6; 1 Chronicles 29:10; Psalm 19:1-3; Isaiah 43:3,15; 64:8; Jeremiah 10:10; 17:13; Matthew 6:9ff.; 7:11; 23:9; 28:19; Mark 1:9-11; John 4:24; 5:26; 14:6-13; 17:1-8; Acts 1:7; Romans 8:14-15; 1 Corinthians 8:6; Galatians 4:6; Ephesians 4:6; Colossians 1:15; 1 Timothy 1:17; Hebrews 11:6; 12:9; 1 Peter 1:17; 1 John 5:7.

JESUS CHRIST

Genesis 18:1ff.; Psalms 2:7ff.; 110:1ff.; Isaiah 7:14; 53; Matthew 1:18-23; 3:17; 8:29; 11:27; 14:33; 16:16,27; 17:5; 27; 28:1-6,19; Mark 1:1; 3:11; Luke 1:35; 4:41; 22:70; 24:46; John 1:1-18,29; 10:30,38; 11:25-27; 12:44-50; 14:7-11; 16:15-16,28; 17:1-5, 21-22; 20:1-20,28; Acts 1:9; 2:22-24; 7:55-56; 9:4-5,20; Romans 1:3-4; 3:23-26; 5:6-21; 8:1-3,34; 10:4; 1 Corinthians 1:30; 2:2; 8:6; 15:1-8,24-28; 2 Corinthians 5:19-21; 8:9; Galatians 4:4-5; Ephesians 1:20; 3:11; 4:7-10; Philippians 2:5-11; Colossians 1:13-22; 2:9; 1 Thessalonians 4:14-18; 1 Timothy 2:5-6; 3:16; Titus 2:13-14; Hebrews 1:1-3; 4:14-15; 7:14-28; 9:12-15,24-28; 12:2; 13:8; 1 Peter 2:21-25; 3:22; 1 John 1:7-9; 3:2; 4:14-15; 5:9; 2 John 7-9; Revelation 1:13-16; 5:9-14; 12:10-11; 13:8; 19:16.

THE HOLY SPIRIT

Genesis 1:2; Judges 14:6; Job 26:13; Psalms 51:11; 139:7ff.; Isaiah 61:1-3; Joel 2:28-32; Matthew 1:18; 3:16; 4:1; 12:28-32; 28:19; Mark 1:10,12; Luke 1:35; 4:1,18-19; 11:13; 12:12; 24:49; John 4:24; 14:16-17,26; 15:26; 16:7-14; Acts 1:8; 2:1-4,38; 4:31; 5:3; 6:3; 7:55; 8:17,39; 10:44; 13:2; 15:28; 16:6; 19:1-6; Romans 8:9-11,14-16,26-27; 1 Corinthians 2:10-14; 3:16; 12:3-11,13; Galatians 4:6; Ephesians 1:13-14; 4:30; 5:18; 1 Thessalonians 5:19; 1 Timothy 3:16; 4:1; 2 Timothy 1:14; 3:16; Hebrews 9:8,14; 2 Peter 1:21; 1 John 4:13; 5:6-7; Revelation 1:10; 22:17.

MAN

Genesis 1:26-30; 2:5,7,18-22; 3; 9:6; Psalms 1; 8:3-6; 32:1-5; 51:5; Isaiah 6:5; Jeremiah 17:5; Matthew 16:26; Acts 17:26-31; Romans 1:19-32; 3:10-18,23; 5:6,12,19; 6:6; 7:14-25; 8:14-18,29; 1 Corinthians 1:21-31; 15:19,21-22; Ephesians 2:1-22; Colossians 1:21-22; 3:9-11.

SCRIPTURAL REFERENCES FOR BELIEFS

SALVATION

Genesis 3:15; Exodus 3:14-17; 6:2-8; Matthew 1:21; 4:17; 16:21-26; 27:22-28:6; Luke 1:68-69; 2:28-32; John 1:11-14,29; 3:3-21,36; 5:24; 10:9,28-29; 15:1-16; 17:17; Acts 2:21,38; 4:12; 15:11; 16:30-31; 17:30-31; 20:32; Romans 1:16-18; 2:4; 3:23-25; 4:3ff.; 5:8-10; 6:1-23; 8:1-18,29-39; 10:9-10,13; 13:11-14; 1 Corinthians 1:18,30; 6:19-20; 15:10; 2 Corinthians 5:17-20; Galatians 2:20; 3:13; 5:22-25; 6:15; Ephesians 1:7; 2:8-22; 4:11-16; Philippians 2:12-13; Colossians 1:9-22; 3:1ff.; 1 Thessalonians 5:23-24; 2 Timothy 1:12; Titus 2:11-14; Hebrews 2:1-3; 5:8-9; 9:24-28; 11:1-12:8,14; James 2:14-26; 1 Peter 1:2-23; 1 John 1:6-2:11; Revelation 3:20; 21:1-22:5.

THE CHURCH

Matthew 16:15-19; 18:15-20; Acts 2:41-42,47; 5:11-14; 6:3-6; 13:1-3; 14:23,27; 15:1-30; 16:5; 20:28; Romans 1:7; 1 Corinthians 1:2; 3:16; 5:4-5; 7:17; 9:13-14; 12; Ephesians 1:22-23; 2:19-22; 3:8-11,21; 5:22-32; Philippians 1:1; Colossians 1:18; 1 Timothy 2:9-14; 3:1-15; 4:14; Hebrews 11:39-40; 1 Peter 5:1-4; Revelation 2:3; 21:2-3.

FUTURE THINGS

Isaiah 2:4; 11:9; Matthew 16:27; 18:8-9; 19:28; 24:27,30,36,44; 25:31-46; 26:64; Mark 8:38; 9:43-48; Luke 12:40,48; 16:19-26; 17:22-37; 21:27-28; John 14:1-3; Acts 1:11; 17:31; Romans 14:10; 1 Corinthians 4:5; 15:24-28,35-58; 2 Corinthians 5:10; Philippians 3:20-21; Colossians 1:5; 3:4; 1 Thessalonians 4:14-18; 5:1ff.; 2 Thessalonians 1:7ff.; 2; 1 Timothy 6:14; 2 Timothy 4:1,8; Titus 2:13; Hebrews 9:27-28; James 5:8; 2 Peter 3:7ff.; 1 John 2:28; 3:2; Jude 14; Revelation 1:18; 3:11; 20:1-22:13

THE FAMILY

Genesis 1:26-28; 2:15-25; 3:1-20; Exodus 20:12; Deuteronomy 6:4-9; Joshua 24:15; 1 Samuel 1:26-28; Psalms 51:5; 78:1-8; 127; 128; 139:13-16; Proverbs 1:8; 5:15-20; 6:20-22; 12:4; 13:24; 14:1; 17:6; 18:22; 22:6,15; 23:13-14; 24:3; 29:15,17; 31:10-31; Ecclesiastes 4:9-12; 9:9; Malachi 2:14-16; Matthew 5:31-32; 18:2-5; 19:3-9; Mark 10:6-12; Romans 1:18-32; 1 Corinthians 7:1-16; Ephesians 5:21-33; 6:1-4; Colossians 3:18-21; 1 Timothy 5:8,14; 2 Timothy 1:3-5; Titus 2:3-5; Hebrews 13:4; 1 Peter 3:1-7.

BAPTISM & THE LORD'S SUPPER

Matthew 3:13-17; 26:26-30; 28:19-20; Mark 1:9-11; 14:22-26; Luke 3:21-22; 22:19-20; John 3:23; Acts 2:41-42; 8:35-39; 16:30-33; 20:7; Romans 6:3-5; 1 Corinthians 10:16,21; 11:23-29; Colossians 2:12.

Our Campus

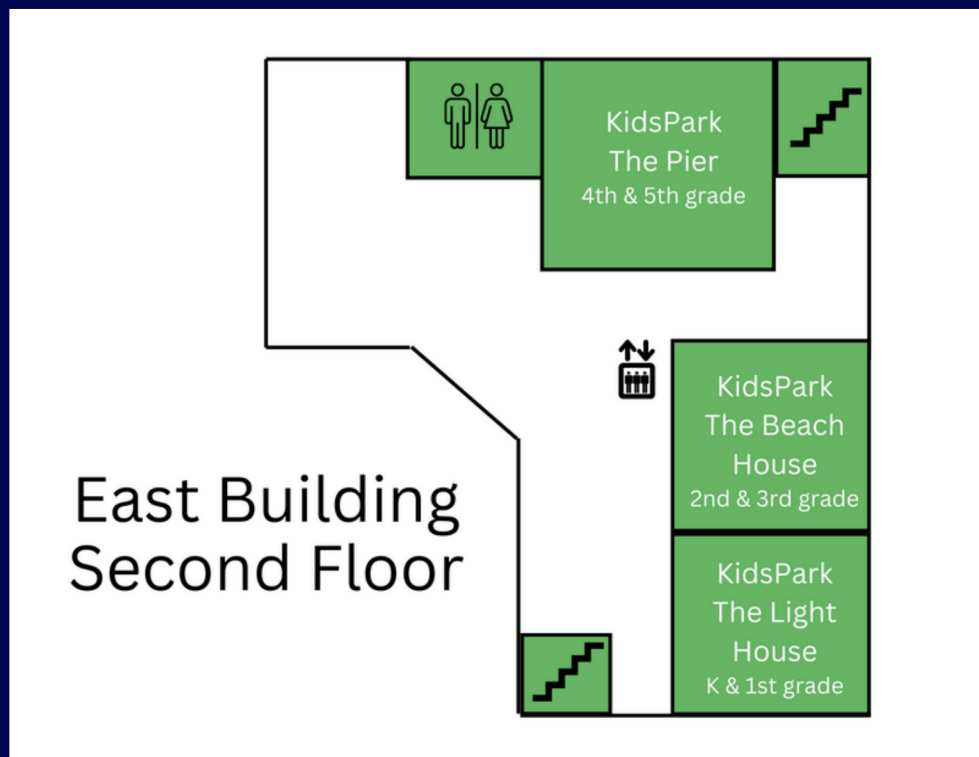
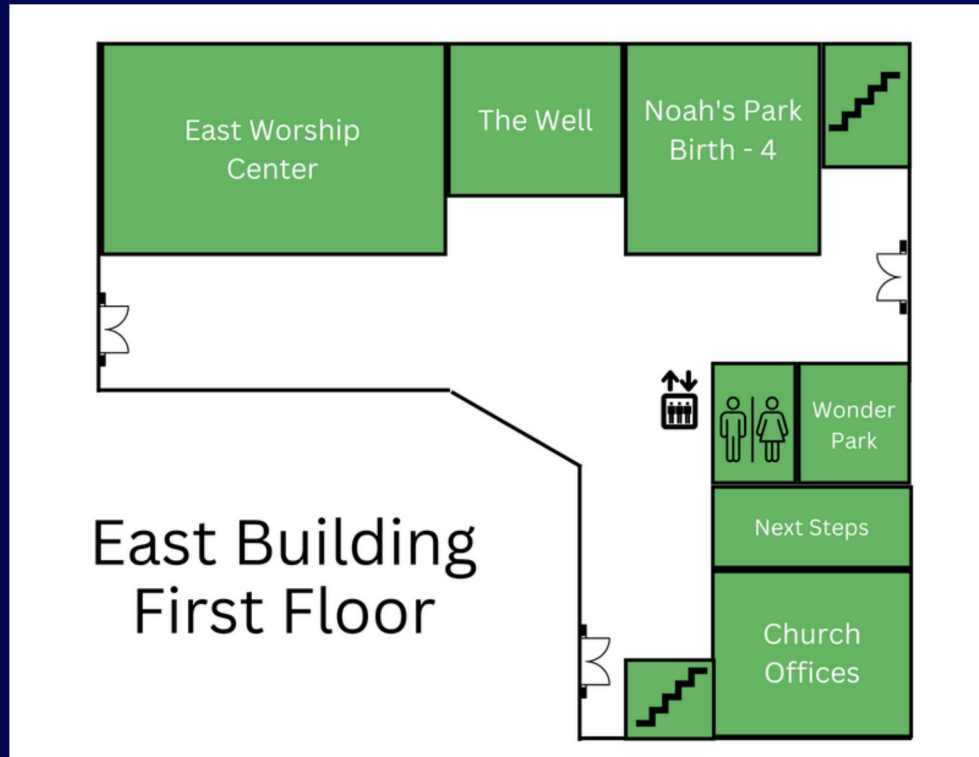

Our Campus

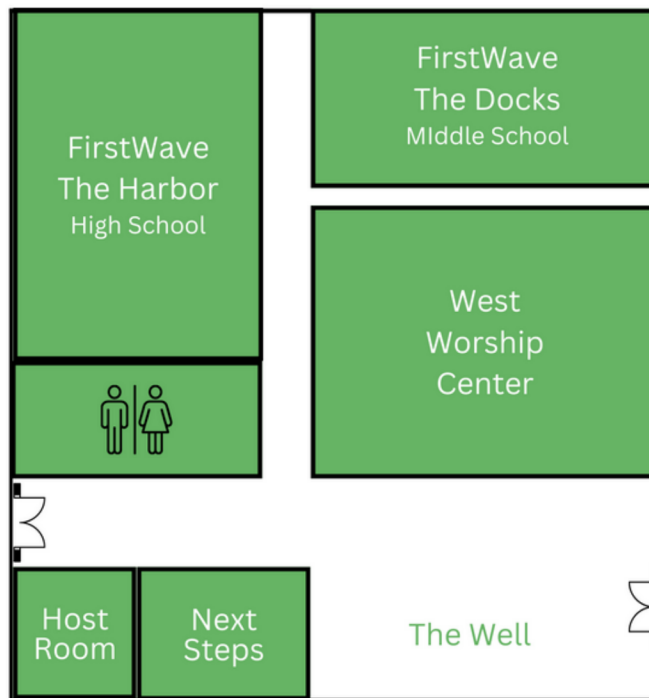

West
Building

CHURCH COVENANT

Because we have received salvation by God's grace through faith in Jesus Christ, and because we have been led by the Holy Spirit to unite with The Church at LifePark, we do enter into this covenant of membership with the other members of this church.

We joyfully commit ourselves to seek to grow into the full likeness of Jesus Christ, to forsake sin, to regularly and cheerfully give of our resources to the support of this church, and to use our gifts, talents, and skills to further the cause of Christ through this church.

By the power of the Holy Spirit we commit ourselves to obey the Great Commandment – to love God with our whole being and to love our neighbors as we love ourselves – and the Great Commission – to make disciples of all nations, baptizing them in the name of the Father, and of the Son and of the Holy Spirit, and teaching them to obey all the commands of Scripture.

We commit ourselves to work for church harmony and unity; to support our church staff and church elders; to participate in worship and service; to provide watchful care over our fellow members; to uphold our church's witness in the community; to uphold our doctrine, discipline, and ordinances.

We agree to these articles of covenant with the help of God and by the witness of the Holy Spirit.

I agree with The Church at LifePark's Statement of Faith and Article III- Church Covenant.

Name: _____ Date: _____

Notes

Notes